

(1) How to fix the B-type wall bracket

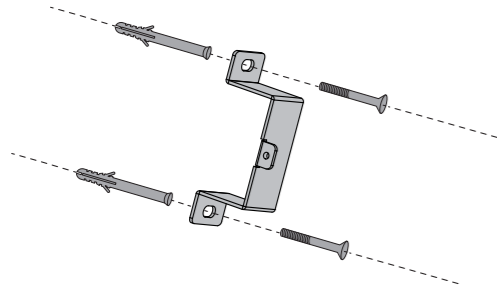

(2) Sketch map

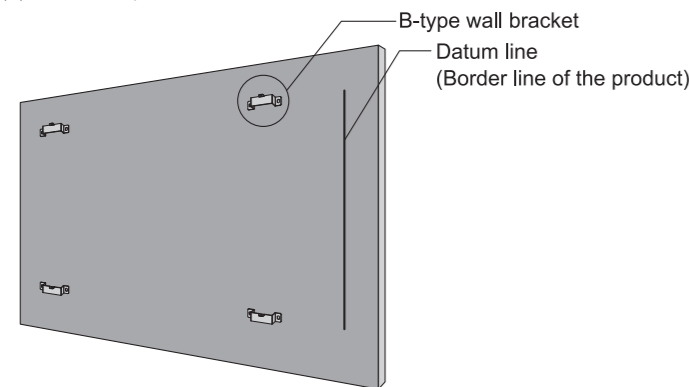

4. Lift the AiO device and make sure the border line of device is at the same horizontal line with datum line. Then hook the four A-type wall brackets and B-type ones.

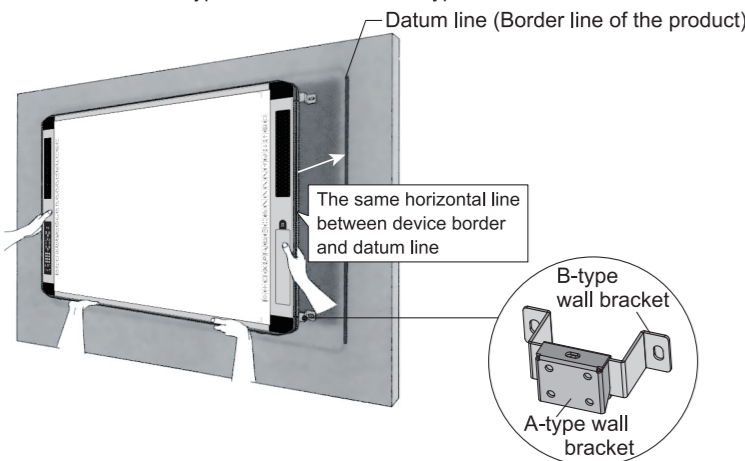

5. Double check the solidity and finish the installation.

Connection Guide

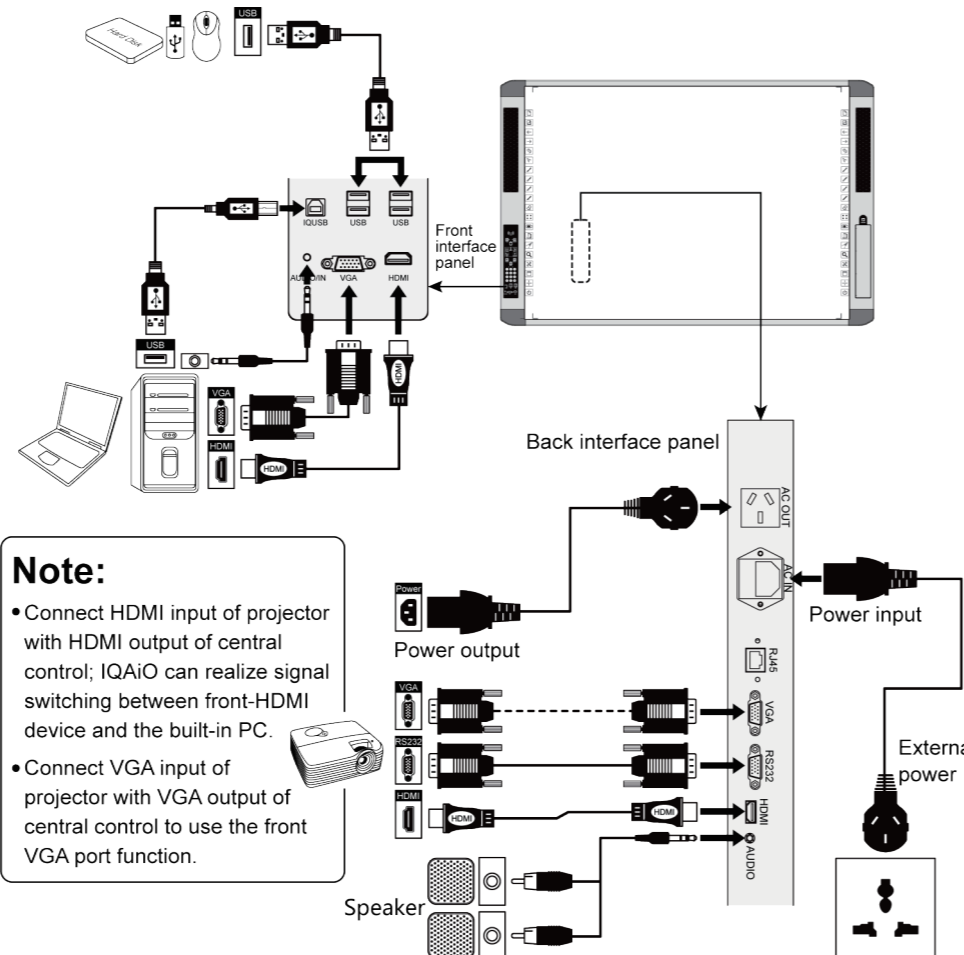

Note:

- Connect HDMI input of projector with HDMI output of central control; IQAiO can realize signal switching between front-HDMI device and the built-in PC.
- Connect VGA input of projector with VGA output of central control to use the front VGA port function.

Attention

- Please use the standard AC adapter to ensure safety and good performance.
- Please plug cable into the ports entirely to avoid loose connection and safety problem.
- Don't try to drag the cables hard which will may cause loose connection.



STOCK CODE
836453



Returnstar Interactive Technology Group CO., LTD.
6th Bldg. High-Tech Base. Fuzhou Fujian Prov. China
0086-591-38202660
0086-591-38203003
www.IQBoard.net
Master@IQBoard.net



IQAiO



Quick Guide

Attentions

- Power supply: AC220V±10% 50/60Hz.
- Don't expose the device to the rain or humidity to avoid fire or electric shock.
- Please shutdown the device at once, power it off and contact technical stuff if any liquid or metal drop inside the device.
- Please keep the device away from the heat, water and the corrosive items.
- Power the device off if you are sure that the thermal dissipation of the projector has completely finished.
- Don't look at the beam out of the projector too long, especially for the children.
- Please use the support software and pen to operate and write.
- The AiO adopts IR technology. Please make sure that after installation the device won't be pressed hard against solid items.
- Please don't drill in the device that will make damages to it.
- Please don't disassemble the device alone. The operation should be conducted with the company of technical stuff.
- Temperature: 0°C ~ +40°C.
- Unplug the power plug before cleaning the device. Use the soft cloth to clean the device.
- Don't use the liquid or gas to clean it.

Introduction

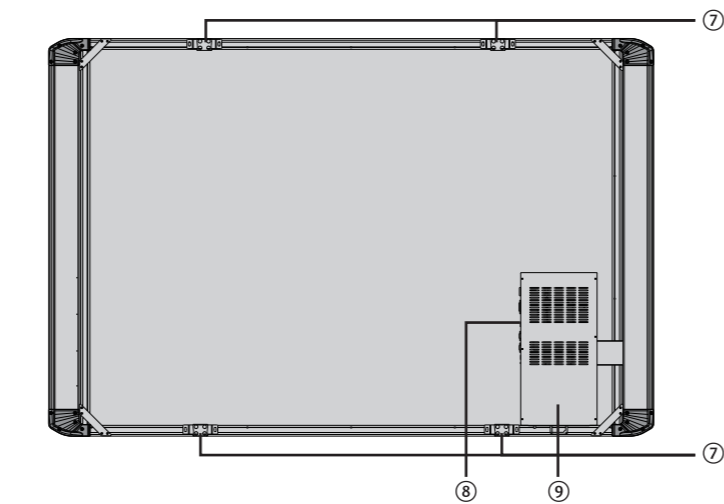

- | | | |
|-------------------------|-------------------|------------------------|
| ① Speaker | ④ Visualizer | ⑦ A-type wall bracket |
| ② Shortcut keys | ⑤ Control panel | ⑧ Back interface panel |
| ③ Solenoid valve switch | ⑥ Interface panel | ⑨ Brand PC or OPS |

Attention

There are four indication lines at the four corners of IWB (such as “┐└┐└”). Please adjust the projection area matching the lines to reach optimized projection and touch effects.

Installation Guide

Installation Guide

- With net weight of 32Kg, the product must be installed upon the solid wall. Please do not install it in the cavity wall or the wooden wall.
- Please install the device with standard accessories, including wall brackets and expansion bolts that come with the product. Otherwise, please make sure that the distance between rear OPS part and the wall is less than 20.0 mm if you don't use the product accessories.

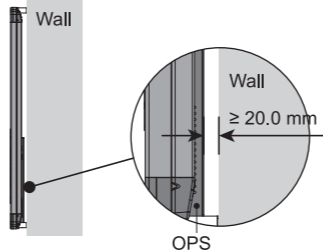

Embedded Installation

Embedded installation is applied to make combination with traditional push-pull blackboards. During installation, please ensure that the distance between blackboard and upper & lower sides of device is at least 20.0 mm. And it's forbidden to cover left & right sides of the devices.

91" (1981mm*1302mm)/102" (2308mm*1302mm)

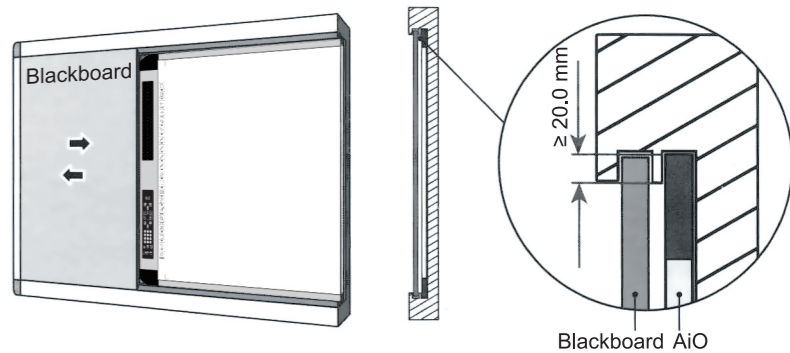
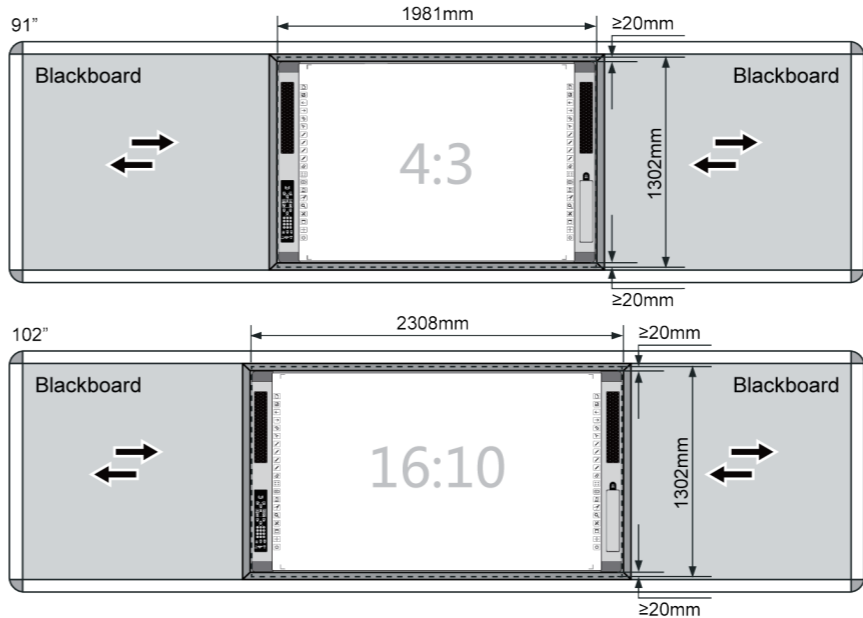

Install with wall brackets

- Take out four B-type wall brackets and eight M8*70 expansion bolts.

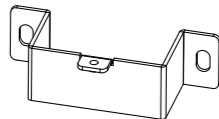

B-type wall bracket



Expansion bolt

- Drill eight holes in Ø 8*50(diameter: 8.0mm, depth: 50.0mm) according to the distance between four A-type wall brackets at the back side of the IQ AiO.

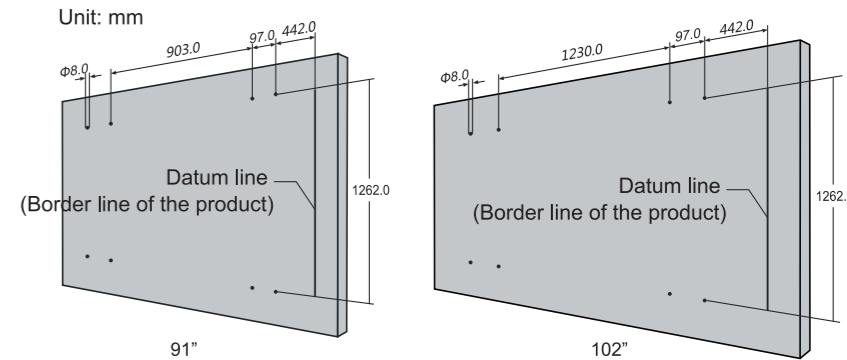

- Fix the M8*70 expansion bolts into the wall and then fix the four B-type wall brackets.