



IQTouch LB900 Series



IQTouch LB900 series is designed to make your meeting more effective. With interactive 20-point touch and built-in wireless screen mirroring software for content sharing, IQTouch LB900 series is helpful for facilitating presentations, brainstorming, and decision-making. All you need in a meeting are seamlessly integrated into the interactive display, just walk in and get your meeting started.



Specifications

Name	IQTouch LB900 Series		
Model	LE065MD	LE075MD	LE086MD
Diagonal Size	65"	75"	86"
LED Light Source	Backlight	Backlight	Backlight
Resolution	3840*2160	3840*2160	3840*2160
Aspect Ratio	16:9	16:9	16:9
Brightness (typ)/(min)	350cd/m ²	350cd/m ²	400cd/m ²
Contrast Ratio (typ)/(min)	4000:1	4000:1	1200:1
Response Rate (typ)/(min)	8ms	8ms	8ms
Refreshing Frequency	60Hz	60Hz	60Hz
Viewing Angle	178° (H), 178° (V)		
Backlight Life Time (typ)/(min)	50,000 hrs		
Display Area (mm)	1428.5*803.5	1651*929.5	1896*1066.9
Depth of Color	8bit	8bit	8bit

Power Supply			
Voltage	100-240V, 50-60 Hz	100-240V, 50-60 Hz	100-240V, 50-60 Hz
Maximum Power	≤210W	≤300W	≤380W
Standby Power	≤0.5W	≤0.5W	≤0.5W

Physical			
Net Weight	39Kg±1 Kg	59.4Kg±1 Kg	64Kg±1 Kg
Gross Weight	49Kg±1Kg	75.4Kg±1 Kg	83Kg±1Kg
Product Size (W*D*H)	1485.74*909.9*90.5	1735.8*107*1069.25	1954.1*1173.7*90.7
Packing Size (W*D*H)	1640*1058*215	1858*220*1195	2115*1332*240
Housing Material	Metal	Metal	Metal
Frame Color	Black	Black	Black



Front Interfaces	
HDMI IN	1
TOUCH-USB	1
USB3.0 (Android & PC)	3

Output Interfaces	
HDMI	1
EARPHONE	1
SPDIF	1
LAN	1
TOUCH-USB	3

Language	
OSD	English, Chinese, etc.

Environmental	
Working Temperature	0°C ~ 40°C
Storage Temperature	-20°C ~ 60°C
Working Humidity	10% ~ 90% RH Non-Condensing
Storage Humidity	20% ~ 80% RH Non-Condensing
Maximum Working Hours (Hours/Day)	18H / 7D
Working Temperature	0°C ~ 40°C

Input Interfaces	
LAN	1
HDMI	2
VGA	1
AUDIO	1
AV	1
YPBPR	1
MIC	1
Type-C	1
USB2.0	1
USB3.0	1
RS232	1

OPS Interfaces (Optional)	
USB2.0	2
USB3.0	2
LAN	1
HDMI	1
LINE-OUT	1
MIC-IN	1

Functions	
Hotspot	YES
Bluetooth	YES
Built-in Speakers	15W*2
Built-in Wifi	2.4G&5G
IQOS	YES



OPS (Optional)	
Chipset	Intel
CPU	Intel® Mobile Core TM i7/i5/i3 and Celeron® Processor
Memory	4GB/8GB/16GB
HDD	500G/1T
SSD(optional)	128G

Android		
CPU	Framework	Dual-core A73 + Dual-core A53
	Dominant Frequency	1.5GHz
	Cores	Quad-Core
RAM		4GB
ROM		32GB
OS Version		Android 8.0

Interactivity		
Technology	Infrared Frame	
Glass	4mm Anti-Glare Tempered Glass, Mohs 7pts	
Glass Transmittance	>92%	
Physical Resolution	32768*32768 (7680*4320 for 70")	
Response Rate	6ms	
Positioning Accuracy	More than 90% of Touch Area: ±2mm	
Input Way	Finger, Pen	
Touch points	20	
Output Form	Coordinate	
Clicking Times	Unlimited	
Minimum Object Size (mm)	1mm	
Minimum Touch Point Detect	1mm	
Light Resistance	light resistance	
Electrical Performance	Interface Type	USB Type A
	Communication	USB2.0 Full speed
	Power Supply	USB
	Voltage	DC 5.0±5%

IQTouch 65"

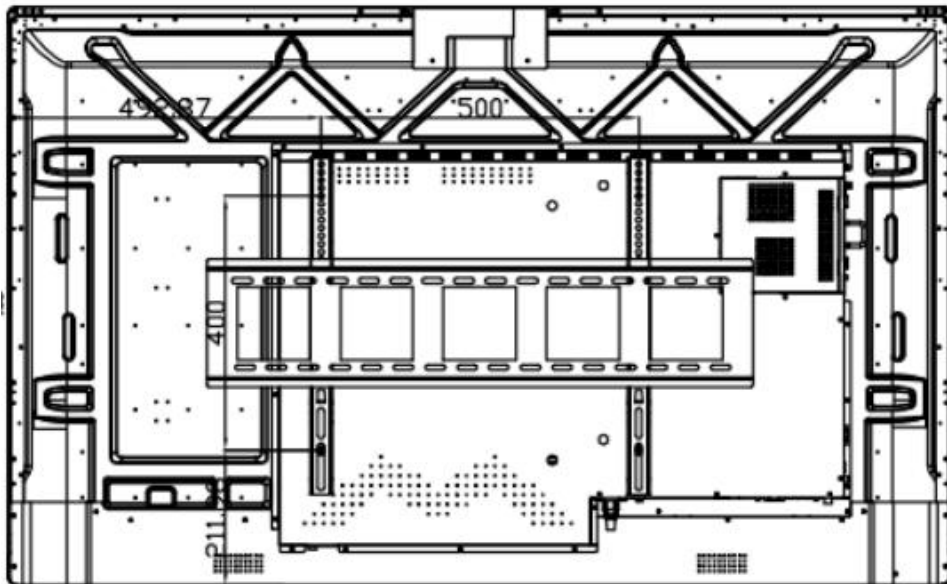
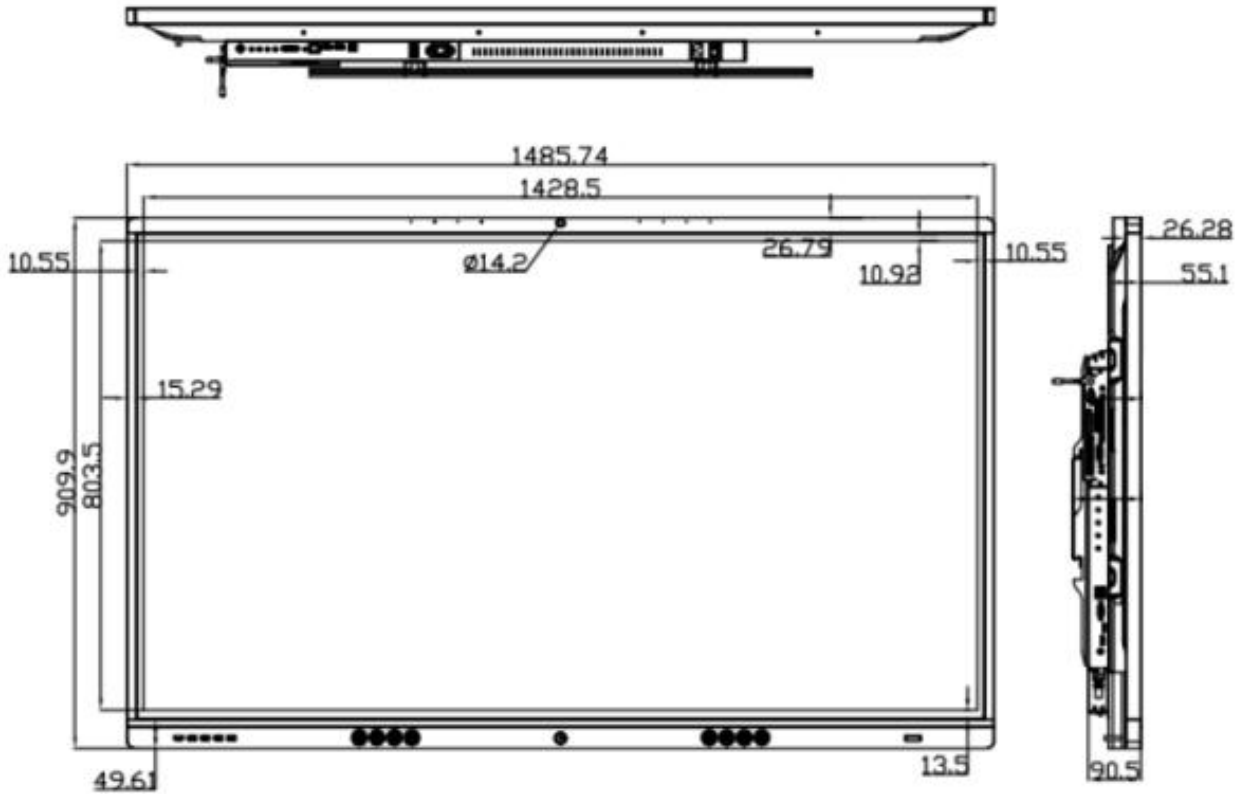

IQTouch75"

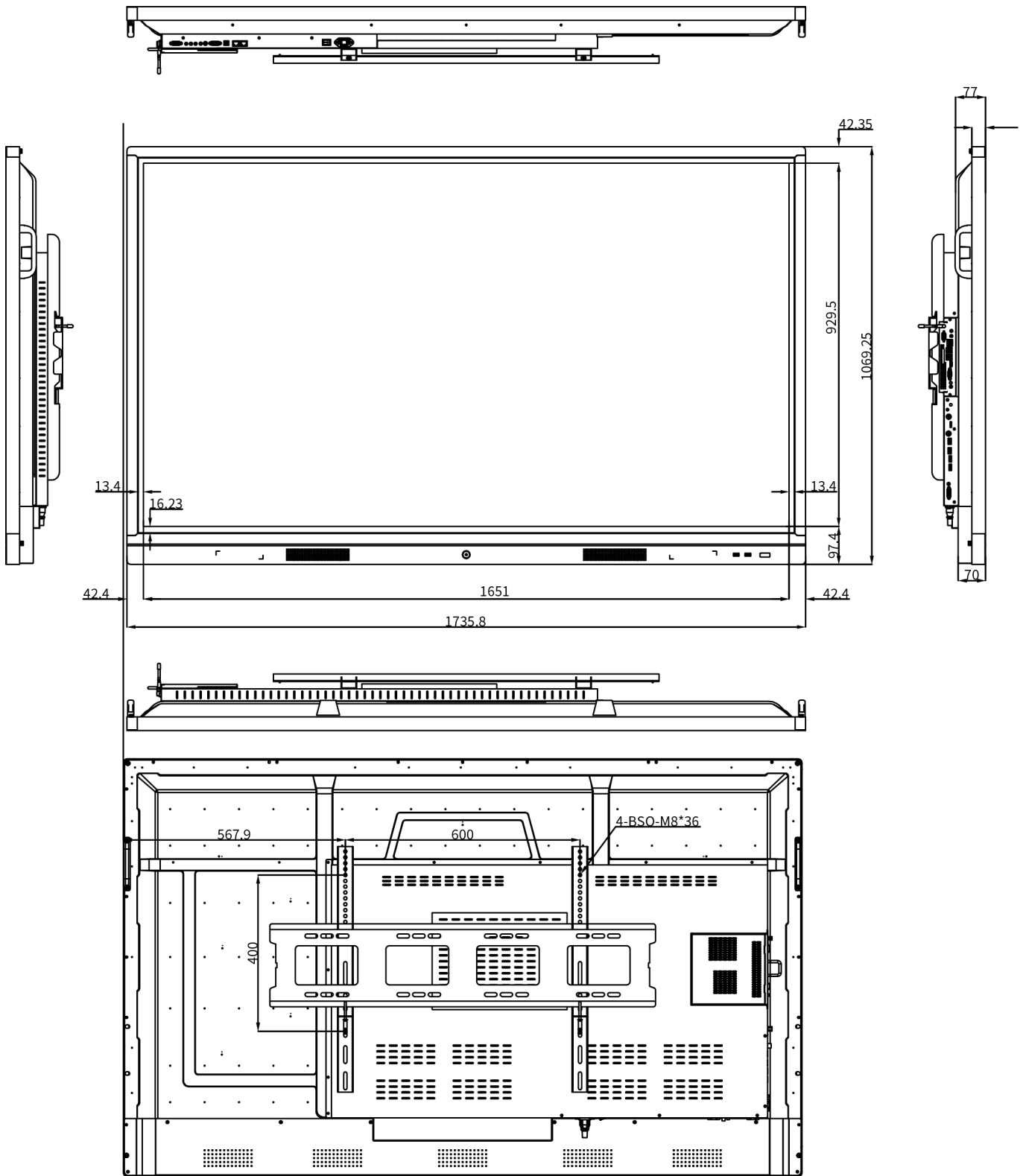



Unit: mm

IQTouch 86"

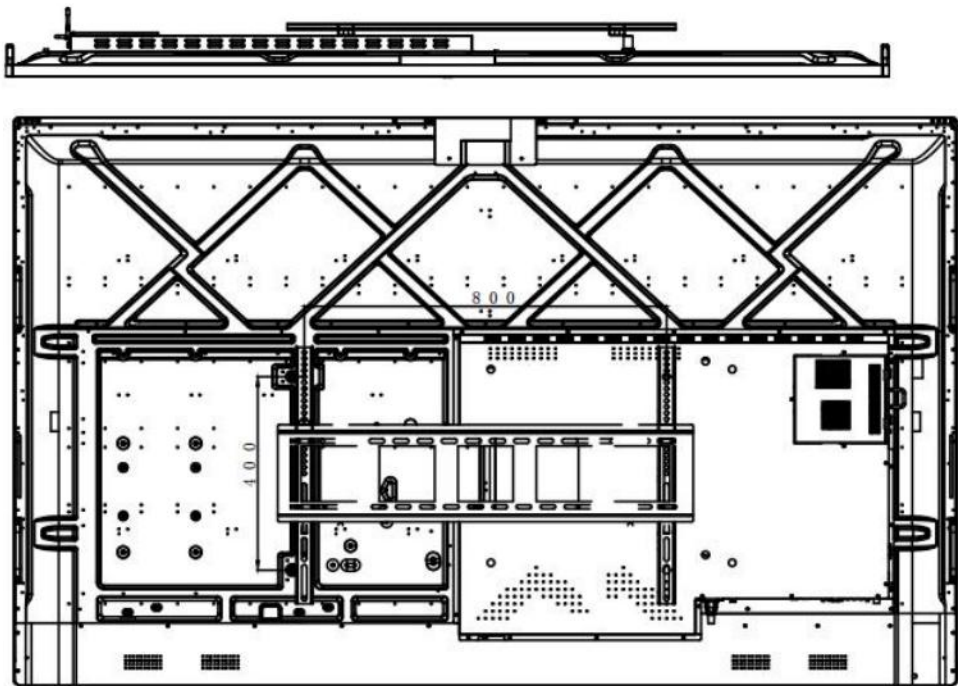
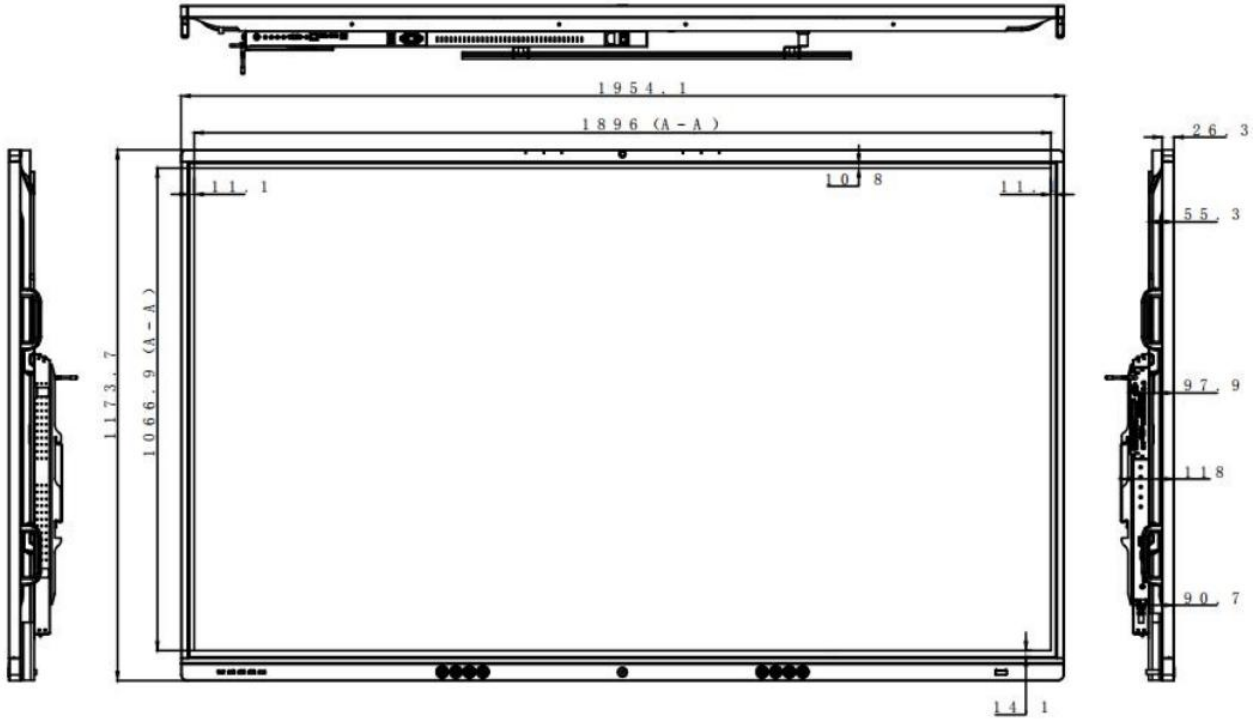

Returnstar Interactive Technology Group CO., LTD.
 6th Bldg. High-Tech Base. Fuzhou Fujian Prov. China
 0086-591-38202660
 0086-591-38203003
 www.IQBoard.net
 master@IQBoard.net



STOCK CODE
836453

